

## AGM30 12V 100Ah

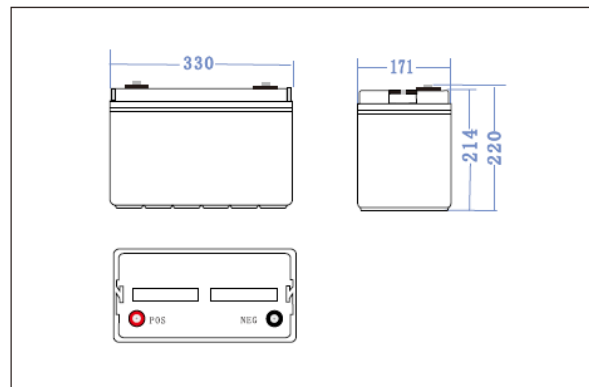

### Dimensions (mm)



### Terminal Type

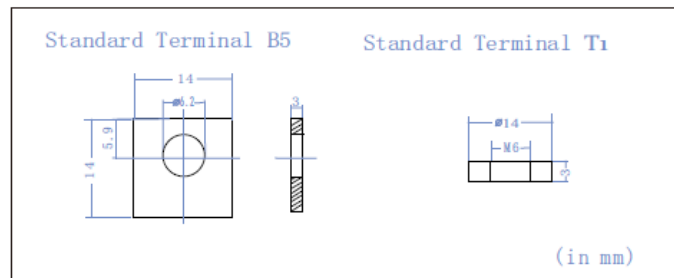

### Electrical Specification

Capacity 25°C (77° F)	10hour rate (10A)	100.0Ah
	5 hour rate (17A)	87Ah
	1 hour rate (55A)	60Ah
Capacity Affected by Temperature (20hour rate)	40°C (104° F)	102%
	25°C (77° F)	100%
	0°C (32° F)	85%
Internal Resistance	Full charged battery 77° F (25°C)	8.5mΩ
	Capacity after 3month storage	91%
	Capacity after 6month storage	82%
Self-Discharge at 25°C (77° F)	Capacity after 12 month storage	64%
	Charge (constant Voltage)	Cycle Initial Charging Current less than 25A Voltage 14.40-14.90V Float Voltage 13.50-13.80V

### Physical specification

Nominal Voltage	12V	
Nominal Capacity (10HR)	100AH	
Dimensions	Length	330±1mm (13.0 inches)
	Width	171±1mm (6.73 inches)
	Container Height	214±2mm (8.43 inches)
	Total height	224±2mm (8.82 inches)
Weight	Approx 27.5kg (60.5 lbs)	
Standard Terminal	B5/T1	

### Cycle service life in relation to depth of discharge

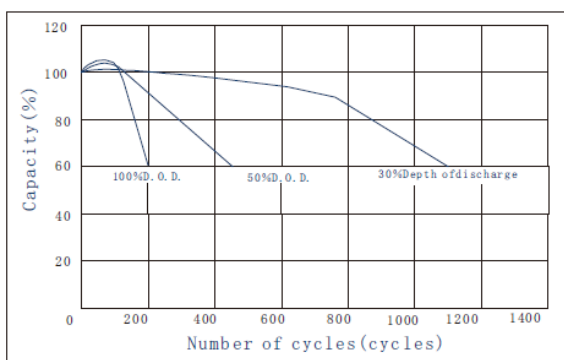

### Discharge Characteristics after fully charged (25°C, 77°F)

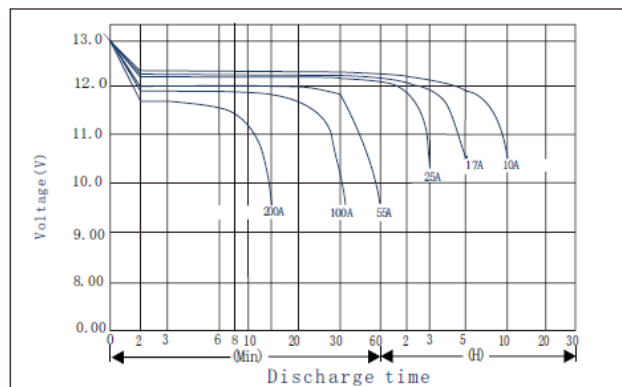

### Constant Current (Amp) and Constant Power (watt) Discharge Table at 25°C, (77°F)

time		10min	15min	30min	1h	2h	3h	4h	5h	8h	10h	20h
9.60V	A	210	165	100.0	62.0	36.5	25.5	20.9	17.8	12.2	10.2	5.3
	W	2245	1803	1115	703	421	298	245	210	145	120.6	63.9
9.90V	A	204.0	161.0	98.0	61.1	36.3	25.4	20.8	17.7	12.2	10.2	5.3
	W	2189	1766	1097	695	419	297	245	209	145	121.0	63.9
10.20V	A	195	155	95.0	59.5	36.0	25.2	20.6	17.6	12.1	10.1	5.3
	W	2100	1707	1067	679	417	295	243	208	144	120.0	63.8
10.50V	A	187	150	92.7	58.0	35.5	25.0	20.5	17.5	12.0	10.1	5.3
	W	2020	1658	1045	664	412	293	242	207	142	120.0	63.4
10.80V	A	176	142	89.3	56.5	34.6	24.3	19.9	17.0	11.6	10.0	5.3
	W	1906	1575	1010	649	402	286	235	202	138	119.0	63.0